

产品参数

PARAMETER

产品品牌:卓超电气

产品型号:SZW26-20/D202.2

Brand:ZHUCO

Model:SZW26-20/D202.2

产品名称:转换开关

约定发热电流(I_{th}):20A

Name:Changeover switch

Conventional heating current:20A

额定绝缘电压(U_i):660V

使用类别/额定工作电流(I_e):AC-15

Rated insulation voltage:660V

Use category:AC-15

使用类别:DC-13

额定工作电压(U_e):440V

Use category:DC-13

Rated working voltage:440V

额定工作电压(U_e):240V

额定工作电流(I_e):20A

Rated working voltage:240V

Rated working current:20A

额定工作电流(I_e):1A

Rated working current:1A

产品介绍

PRODUCT DESCRIPTION

1-0-2 三档两节 转换开关

1-0-2 THREE GEARS TWO SECTIONS CHANGEOVER SWITCH

SZW26-20/D202.2(PANEL:1 0 2)



0档停止, 1档2档各通两路
0 GEAR OFF, 1 AND 2 GEARS ON
(X MEANS CONNECTED)

	1	3	5	7	
0					
1					
2					
2P	45°	2	4	6	8
1		X	X		
0					
2			X	X	

产品尺寸图

PRODUCT DRAWING

48X48MM PANEL

尺寸单位/Size unit:mm

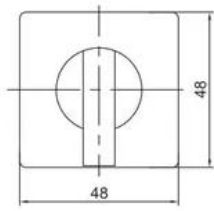

面板尺寸/Panel size

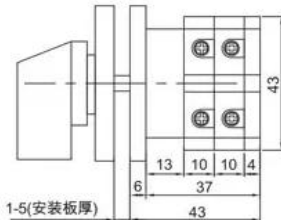

外形尺寸/Shape size

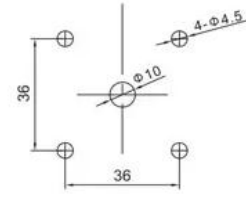

安装尺寸/Installation size

64X64MM 大面板/BIG PANEL 尺寸单位/Size unit:mm

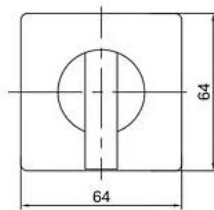

面板尺寸/Panel size

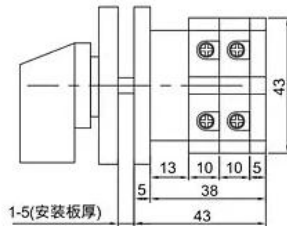

外形尺寸/Shape size

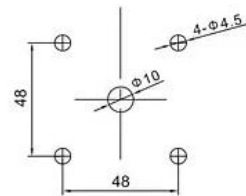

安装尺寸/Installation size

PRODUCT
ADVANTAGES

产品优势



运行稳定

WORK SMOOTHLY



转换灵活

FLEXIBLE CONVERSION



坚固外壳

ROBUST HOUSING



加厚镀锌铜件
Thickened galvanized
copper pieces

银合金触点
Silver alloy contacts

阻燃PC塑壳
Flame Retardant PC Plastic Case